



GE combines our rugged design of stainless steel membrane element housings with 30+ years of history in the applications of RO/NF/US machine assembly.

Sanitary Stainless Steel Membrane Housing

3A Approved 8-inch Side Entry

Why Stainless Steel

- > No seals involved in side port connections
- > Unlike fiberglass, doesn't warp or weep
- > Is not affected by UV rays or sunlight
- > Stainless steel is a preferred and universally accepted material for water systems and sanitary process applications
- > Can withstand high temperatures, up to 200°F
- > Capable of supporting process piping
- > During assembly, stainless housings are lighter and easier to handle than PVC and FRP housings with equivalent pressure ratings

Features and Benefits

The design and fabrication of the membrane housing and endcap have been reviewed and approved by the USDA. Largest port available in any membrane housing design. Allows for superior flow and reduced pressure drop. All ports are tri-clamp connections with 180 grit polished ID. Welds and edges are all polished to be smooth and tapered to eliminate the potential for any product hold-up. A superior finish is available on these housings by electropolishing or mechanically polishing the stainless steel, or by using a metallic two-coat epoxy paint.

Options Available

Grade — 304L Stainless Steel and 316L Stainless Steel

Housing Pressure Drop Graph

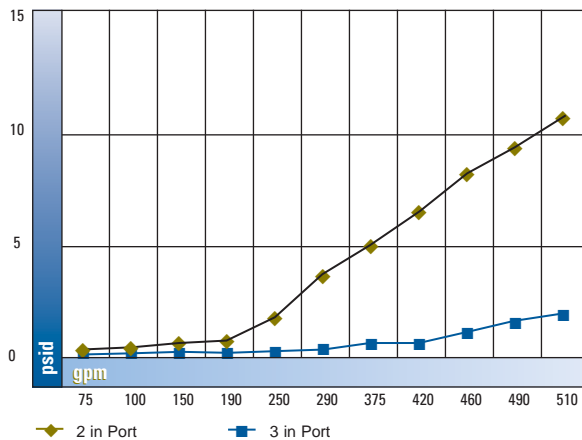

Side Ports — 2" and 3" port, Multi-port; (2 port standard)
 Exterior Finishes — Electropolished for a glossy, shiny, metallic look
 — Bead blast surface
 — Metallic painted epoxy
 — Mechanical polished (180 grit)

Victaulic Coupling — Galvanized Steel
 Coupling Gasket — EPDM
 Support Straps — 304 SS
 Mounting Supports — 304 SS
 O-Ring — EPDM
 Housing Body — 304/304L or 316/316L SS

Materials of Construction

End Cap — 316 SS

Note: End Cap adapters are available for all major membrane element manufacturers.

Dimensions

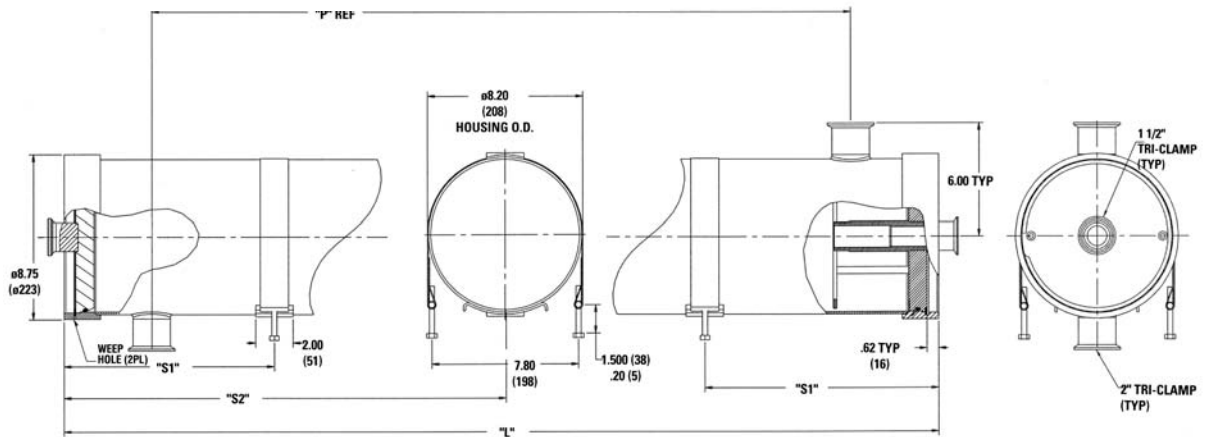

Element Length	"L" Length	"P" Length	Two Supports Recommended "S1"*		3 Supports Recommended (1 Centered) "S2"*		Approx. Empty WT Lbs. (KG)	
2-8x40	92.1 (2339)	82.8 (2103)	15.0 (381)	N/A	N/A	106 (48)		
3-8x40	132.2 (3358)	122.8 (3119)	23.0 (584)	N/A	N/A	138 (62)		
4-8x40	172.2 (4374)	162.9 (4138)	31.0 (787)	N/A	N/A	169 (76)		
5-8x40	212.3 (5392)	202.9 (5154)	28.0 (711)	106.2 (2697)		210 (91)		
6-8x40	252.3 (6408)	243.0 (6172)	34.0 (864)	126.2 (3205)		232 (105)		

* The S1 and S2 dimensions are the recommended housing support locations measured from each end of the housing. If there is no S2 dimension, then no middle support is required (i.e., use the two end supports only).

Specifications

802P - 3A

802P - TC

Material	304 or 316 SS	304 or 316 SS
Design	600 psi	600 psi
Closure Kits	316 SS	316 SS
Tested at	3 times design pressure	3 times design pressure
Tested Cycles	100,000 cycles at design pressure	100,000 cycles at design pressure
Element Capacity	2 - 6 long	2 - 6 long
Number of Side Ports	2	2
Side Port Size and Connection	2" Tri-Clamp (option for 3")	2" Tri-Clamp (option for 3")
3A Approved Design	Yes	No
Interior Finish	180 grit mechanical polish	Mill finish
Exterior Finish	Mill finish	Mill finish
End Cap & Load Transfer	SS and 3A Design	SS
Permeate Port	1.5" Tri-Clamp	1.5" Tri-Clamp

